

MAY 10 1972

VILLAGE OF CHASE
BY-LAW NO. 58

APR 11 1972

A By-law of the Village of Chase to change the zoning classification of Lot 2 of D.L. 517, Plan 1467 except Plans 7349 and 8227 from A1 Rural to M1 Mobile Home.

The Council of the Village of Chase, in open meeting assembled enact as follows:

1. The zoning classification of all of Lot 2 of D.L. 517, Plan 1467 except Plans 7349 and 8227, as shown outlined in red on the attached plan, is hereby changed from A1 Rural to M1 Mobile Home.
2. This By-law may be cited as, "Village of Chase Zoning Amendment By-law No. 58, 1972."

READ A FIRST TIME THIS 9th DAY OF MARCH 1972
 READ A SECOND TIME THIS 9th DAY OF MARCH 1972
 READ A THIRD TIME THIS 9th DAY OF MARCH 1972

Presented to a public meeting of the ratepayers of the Village of Chase this 23rd day of MARCH 1972.

Cloyd W. Spicer
Clerk

I hereby certify the foregoing to be a true and correct copy of By-law No. 58 cited as "Village of Chase Zoning Amendment By-law No. 58, 1972" as read a third time by Council on the 9th day of MARCH 1972

Dated this 24th day of MARCH 1972.

Cloyd W. Spicer
Clerk

Approved by the Minister of Highways on the 1st day of May 1972

MGEKtar
Minister of Highways

Reconsidered and adopted on this 25 day of MAY 1972.

S. Alca Brown
Mayor
Cloyd W. Spicer
Clerk

I hereby certify the foregoing to be a true and correct copy of By-law No. 58 as adopted on the 25 day of MAY 1972.

Cloyd W. Spicer
Clerk

RECEIVED
MAY 10 1972
M. G. ARM, B. C.
DEPT. OF HIGHWAYS

A true copy of By-law No. 58 registered in the office of the Inspector of Municipalities this 5th day of June 1972.

M. K. Smith
Deputy Inspector of Municipalities

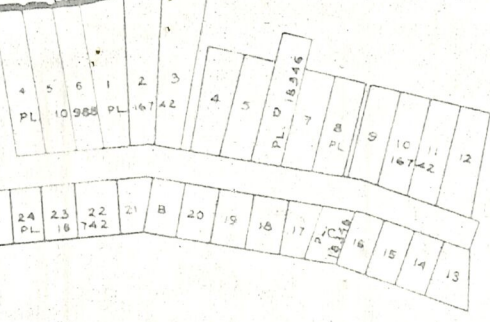
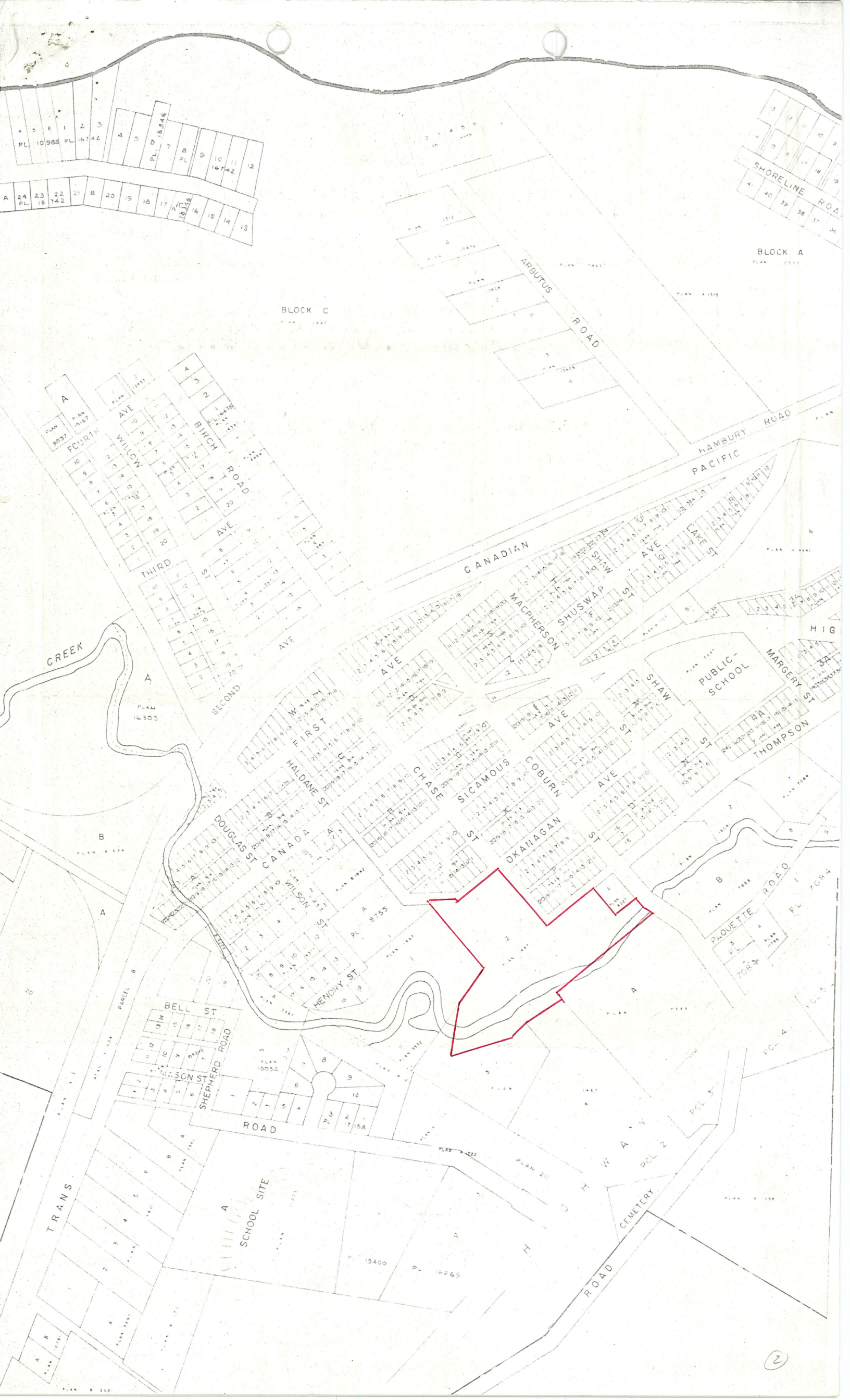

BLOCK C
PLAN 1947

BLOCK A
PLAN 2517

FOURTH AVE
WILLOW AVE
BIRCH ROAD
THIRD ST
SECOND AVE

CANADIAN

HAMBURY ROAD
PACIFIC

CREEK

PLAN 16303

DOUGLAS ST

WILSON ST

MACPHERSON

SHUSWAP

SHAW

LAKE ST

HIGH

PUBLIC SCHOOL

MARGERY ST

HALDANE ST

CHAPMAN

SICAMOUS

COBURN

OKANAGAN

SHAW

THOMPSON

DOUGLAS ST CANADA

WILSON ST

HENRY ST

PAQUETTE ROAD

PAQUETTE ROAD

PAQUETTE ROAD

PAQUETTE ROAD

PAQUETTE ROAD

PAQUETTE ROAD

PAQUETTE ROAD

PAQUETTE ROAD

PAQUETTE ROAD

BELL ST

MASON ST

SHEPHERD ROAD

ROAD

ROAD

ROAD

ROAD

ROAD

ROAD

ROAD

ROAD

ROAD

SCHOOL SITE

PL 15400

PL 16965

CEMETERY

ROAD

ROAD

ROAD

ROAD