

VILLAGE OF CHASE

ZONING AMENDMENT BY-LAW NO. 118, 1975

A By-law of the Village of Chase to change the zoning classification from A.1 Rural to C.2 Highway Commercial of that part lying within the boundary starting at the south-easterly corner pin of Lot 2, Plan 19564, D.L. 517, K.D.Y.D., in a south-easterly direction for a distance of 32.12 feet, then to a south by south-west direction (paralleling the Old Trans-Canada Highway) for a distance of 227.40 feet, changing direction to west by north-west for a distance of 32.12 feet and returning in a straight line to the starting point, as shown outlined in red on the attached plan, all being part of D.L. 517, K.D.Y.D., Plan B.5021, except Plans B.5674, 5030, B.6665, B.6910, 10791, and 14290.

The Council of the Village of Chase, in open meeting assembled, ENACTS AS FOLLOWS:-

- 1. The zoning classification of that part lying within the boundary starting at the south-easterly corner pin of Lot 2, Plan 19564, D.L. 517, K.D.YD., in a south-easterly direction for a distance of 32.12 feet, then to a south by south-west direction (paralleling the Old Trans-Canada Highway) for a distance of 227.40 feet, changing direction to west by north-west for a distance of 32.12 feet and returning in a straight line to the starting point, as shown outlined in red on the attached plan, all being part of D.L. 517, K.D.Y.D., Plan B.5021, except Plans B.5674, 5030, B.6665, B.6910, 10791, and 14290, is hereby changed from A.1 Rural to C.2 Highway Commercial.
2. This By-law may be cited as "Village of Chase Zoning Amendment By-law No. 118, 1975".

READ a first time this 9th day of January, 1975.

READ a second time this 9th day of January, 1975.

READ a third time this 9th day of January, 1975.

Presented at a public meeting of the ratepayers of the Village of Chase this 23rd day of January, 1975.

[Signature]
Clerk

I hereby certify the foregoing to be a true and correct copy of By-law No. 118 cited as "Village of Chase Zoning Amendment By-law No. 118, 1975" as read a third time by Council on the 9th day of January, 1975.

Dated this 24th day of January, 1975.

[Signature]
Clerk

Approved for the Minister of Highways this 3rd day of February, 1975.

(Signed) "D. L. South"

Reconsidered and Adopted on this 27th day of February, 1975.

[Signature]
Mayor

[Signature]
Clerk

I hereby certify the foregoing to be a true and correct copy of By-law No. 118 as adopted on the 27th day of February, 1975.

A true copy of By-law No. 118 registered in the office of the Inspector of Municipalities this 1st day of February 1975

[Signature]

Deputy Inspector of Municipalities

[Signature]
Clerk

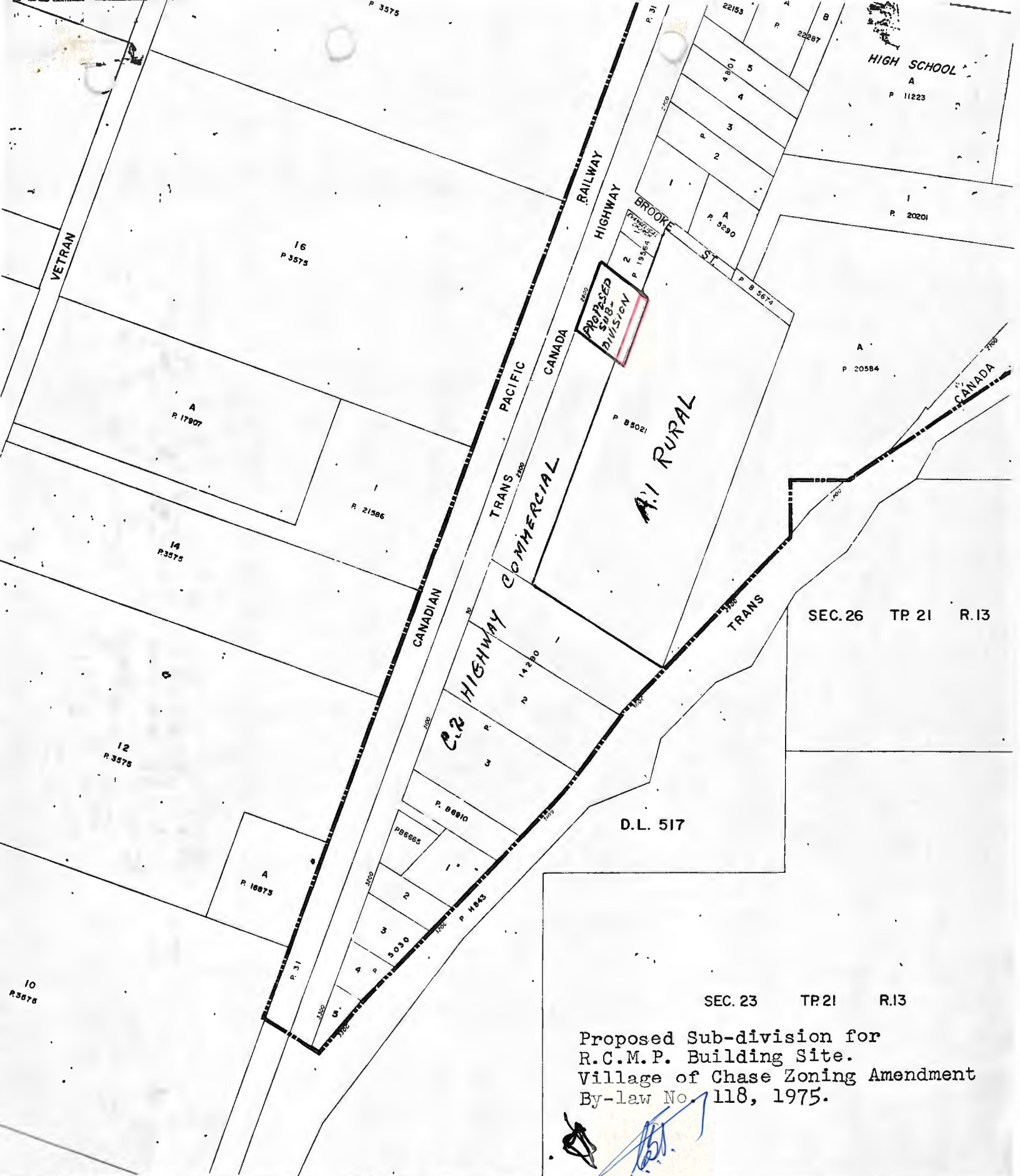

Proposed Sub-division for  
 R.C.M.P. Building Site.  
 Village of Chase Zoning Amendment  
 By-law No. 118, 1975.

*[Handwritten signature]*

A true copy of By-law No. 118 registered in the office of the Inspector of Municipalities this 1st day of April 1975.

VILLAGE OF CHASE

ZONING AMENDMENT BY-LAW NO. 118, 1975 Deputy Inspector of Municipalities

A By-law of the Village of Chase to change the zoning classification from A.1 Rural to C.2 Highway Commercial of that part lying within the boundary starting at the south-easterly corner pin of Lot 2, Plan 19564, D.L. 517, K.D.Y.D., in a south-easterly direction for a distance of 32.12 feet, then to a south by south-west direction (paralleling the Old Trans-Canada Highway) for a distance of 227.40 feet, changing direction to west by north-west for a distance of 32.12 feet and returning in a straight line to the starting point, as shown outlined in red on the attached plan, all being part of D.L. 517, K.D.Y.D., Plan B.5021, except Plans B.5674, 5030, B.6665, B.6910, 10791, and 14290.

The Council of the Village of Chase, in open meeting assembled, ENACTS AS FOLLOWS:-

1. The zoning classification of that part lying within the boundary starting at the south-easterly corner pin of Lot 2, Plan 19564, D.L. 517, K.D.Y.D., in a south-easterly direction for a distance of 32.12 feet, then to a south by south-west direction (paralleling the Old Trans-Canada Highway) for a distance of 227.40 feet, changing direction to west by north-west for a distance of 32.12 feet and returning in a straight line to the starting point, as shown outlined in red on the attached plan, all being part of D.L. 517, K.D.Y.D., Plan B.5021, except Plans B.5674, 5030, B.6665, B.6910, 10791, and 14290, is hereby changed from A.1 Rural to C.2 Highway Commercial.
2. This By-law may be cited as "Village of Chase Zoning Amendment By-law No. 118, 1975."

READ A FIRST TIME THIS 9<sup>th</sup> DAY OF JANUARY, 1975.  
 READ A SECOND TIME THIS 9<sup>th</sup> DAY OF JANUARY, 1975.  
 READ A THIRD TIME THIS 9<sup>th</sup> DAY OF JANUARY, 1975.

Presented at a public meeting of the ratepayers of the Village of Chase this 23<sup>rd</sup> day of JANUARY, 1975.

  
Clerk

I hereby certify the foregoing to be a true and correct copy of By-law No. 118 cited as "Village of Chase Zoning Amendment By-law No. 118, 1975" as read a third time by Council on the 9<sup>th</sup> day of JANUARY, 1975.

Dated this 24<sup>th</sup> day of JANUARY, 1975.

  
Clerk

Approved <sup>for</sup> by the Minister of Highways this 3<sup>rd</sup> day of Feb, 1975.



Reconsidered and Adopted on this 27th day of February, 1975.

  
Mayor

  
Clerk

I hereby certify the foregoing to be a true and correct copy of By-Law no. 118 as adopted on the 27th day of February, 1975.

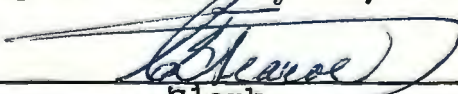
  
Clerk